



149/5 Wulumay Close 'Balmain Cove' ROZELLE NSW

2 🛏 2 🚿 2 🚗

Offering a massive 174 m2 of living space featuring absolute privacy and a lovely tropical garden outlook with waterviews this superb apartment located in the 'Balmain Cove' waterfront complex offers extensive indoor & outdoor entertaining spaces and takes in a favourable sun filled northerly aspect.

Price : SOLD FOR \$1,090,000
Land Size : 207 sqm
View : <https://www.balmainrealty.com/1P0819>

Property features;

- * Offering very spacious living set over 174 m2
- * Generous living area that opens seamlessly onto a sun drenched north facing terrace
- * Separate dining area or ideal home office
- * Private gate access onto rooftop garden & swimming pool
- * Two spacious & light filled bedrooms separated by the living areas. Both feature built-in robes & direct access onto terrace

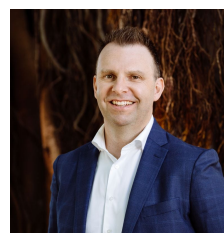

Scott Robertson
(02) 9818 8888

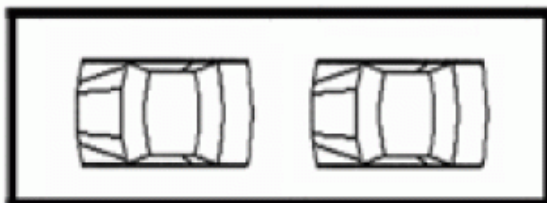
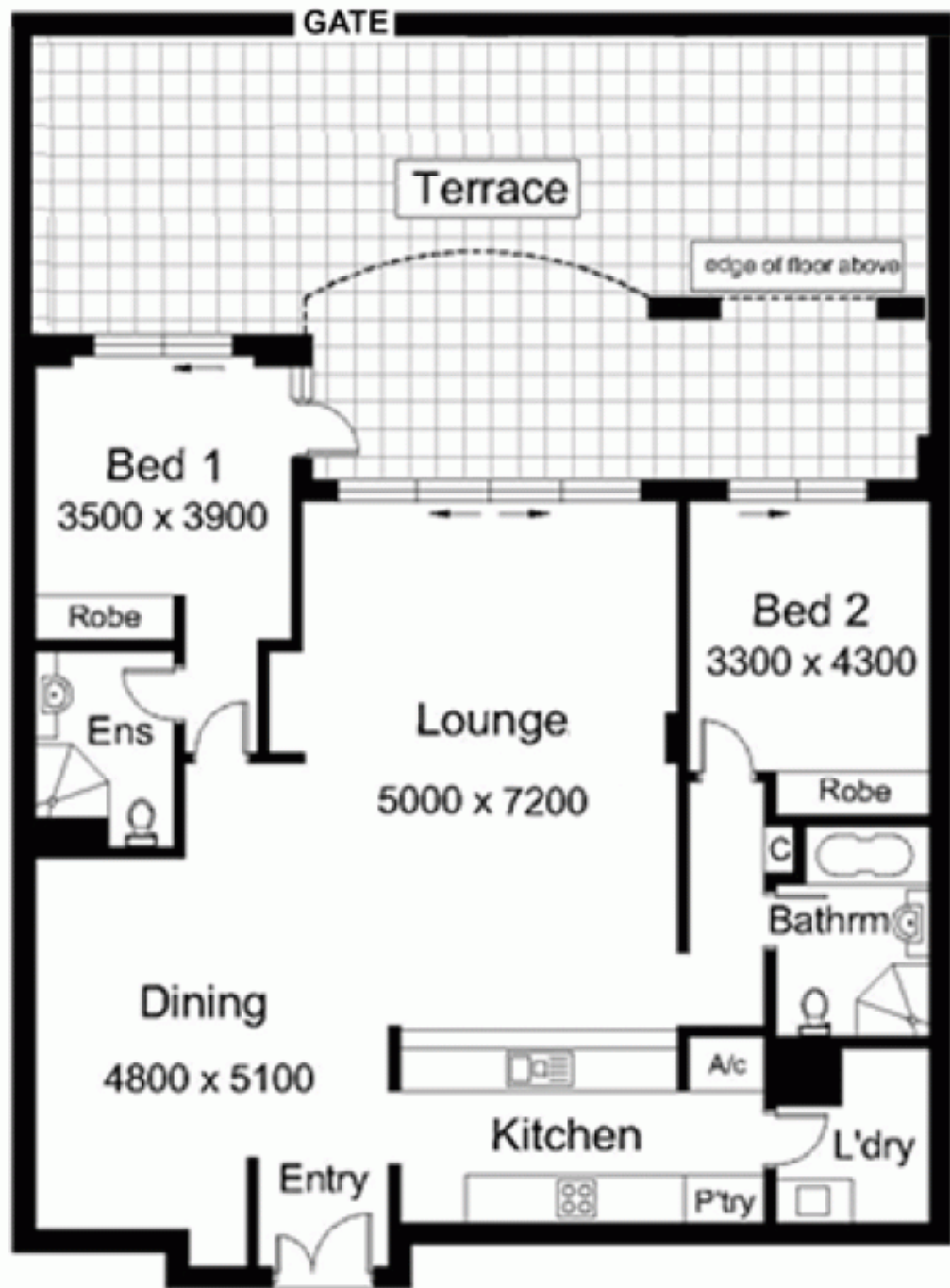

Double Lock-up Garage

Every precaution has been taken to establish the accuracy of the included information but does not constitute any representation by the vendor or agent. All interested parties should make their own enquiries to verify the information contained in this document. Refer to contract of sale for actual inclusions.