



510/11 Warayama Place 'Balmain Shores' ROZELLE NSW

1 1 1

This fabulous larger than your average studio apartment located on the waterfront of the resort style "Balmain Shores" complex features stunning water views and parkland outlook all just minutes walk from transport and Darling Street's cosmopolitan cafes & restaurants.

Property features include;

- Spacious open plan living & large balcony set over 50m2
- Top floor position
- Stunning harbour views
- Sun drenched living with North-East aspect
- Gourmet kitchen with granite benchtops with gas cooking, rangehood and dishwasher
- Large bedroom area with built-in wardrobes
- Stylish bathroom

Price : SOLD FOR \$460,000

View : <https://www.balmainrealty.com/1P0841>



Scott Robertson
(02) 9818 8888

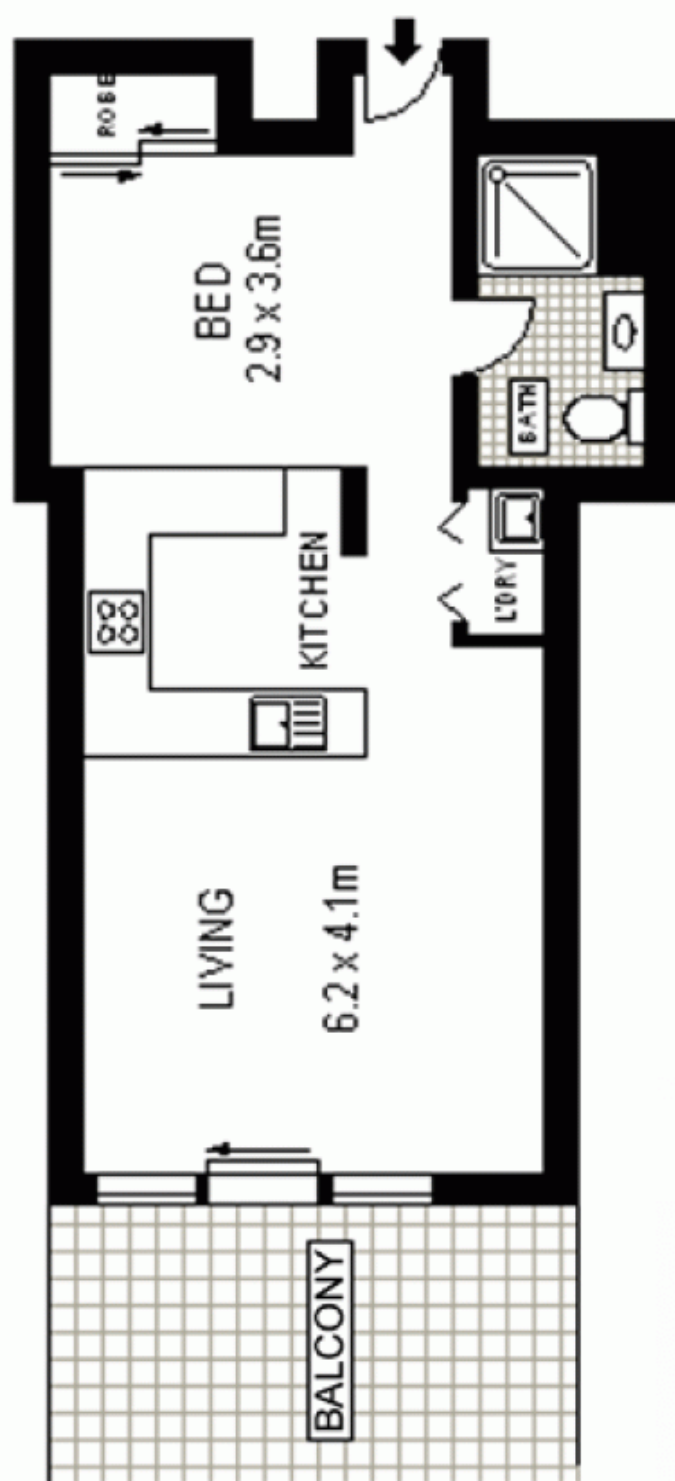

Every precaution has been taken to establish the accuracy of the above & reverse side information, but does not constitute any representation by the vendor or agent. Interested parties should make their own enquiries to verify the information contained in this document. Refer to contract of sale for actual inclusions.