



47/3 Wulumay Close 'Balmain Cove' ROZELLE NSW

3 2 2

Offering multiple outdoor areas including a huge sun drenched wrap around terrace with water views & tropical garden outlook, and a large rear garden courtyard this stunning 3 bedroom apartment located in the "Balmain Cove" waterfront complex offering resort style facilities and marina facility for the boating enthusiast is sure to tick all of your boxes.

Property features include;

- Large indoor/outdoor living set over 221m2
- Living spaces flooded in natural light all year round
- Private & tropical leafy outlook with water views
- Gourmet family sized kitchen with granite benchtops, stainless steel appliances with gas cooking and large pantry
- Polished timber floors throughout

Price : SOLD FOR \$1,187,500
Land Size : 255 sqm
View : <https://www.balmainrealty.com/1P0843>



Scott Robertson
 (02) 9818 8888

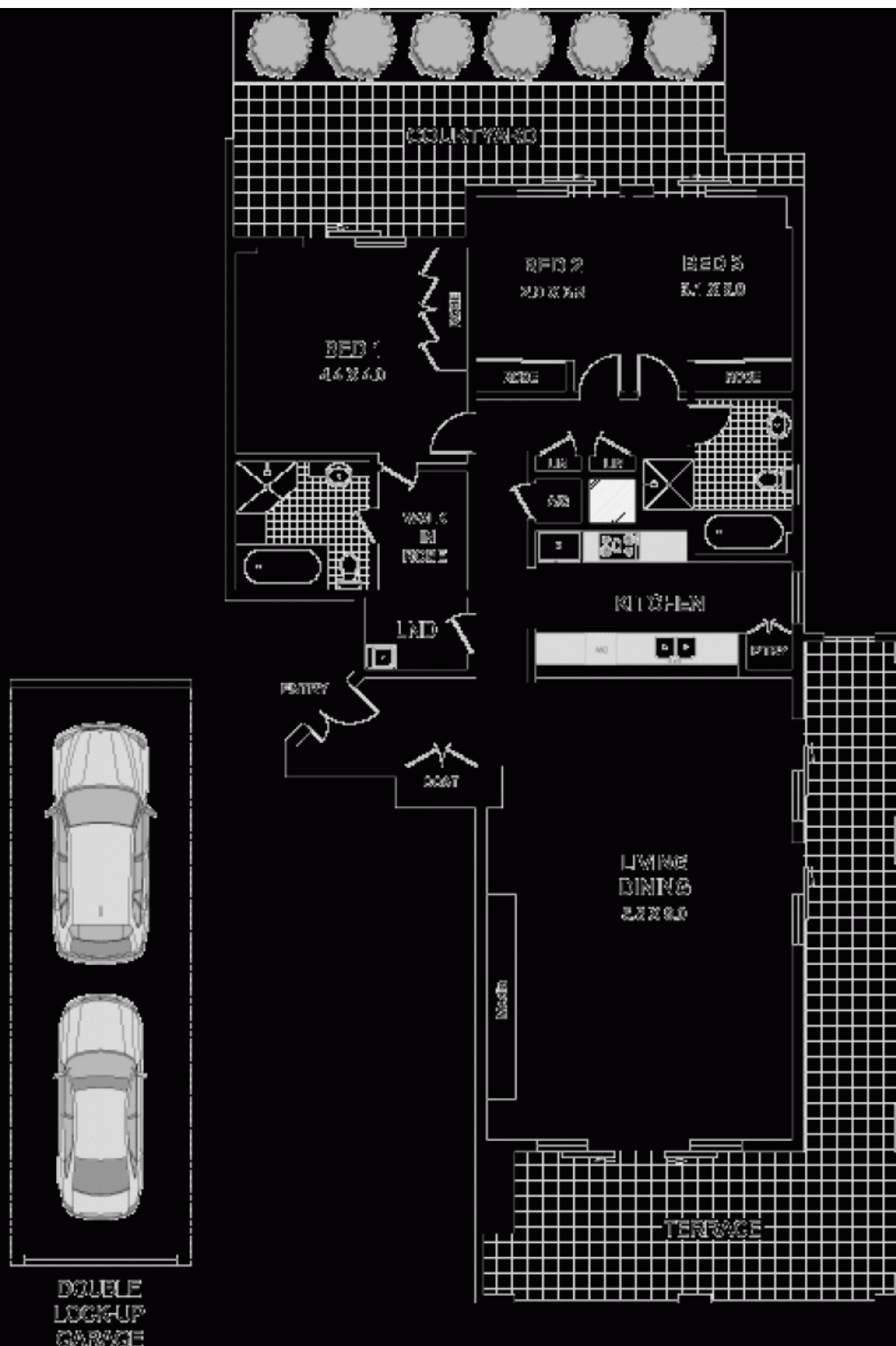

This plan is to be taken as a guide only and does not constitute a guarantee of accuracy. It should not be used for any purpose other than for general information only and is not to be relied upon for any other purpose.



REAL ESTATE INSTITUTE
OF NEW SOUTH WALES

47/2 WULUMAY CLOSE
ROZELLE