



612/3 Warayama Place ROZELLE NSW

3 2 2

Taking in spectacular sweeping harbour views from a commanding outlook & top floor position this spacious three bedroom apartment located in the 'Balmain Shores' waterfront complex offers well appointed living spaces that flow onto a large wrap around balcony with custom Vergola louvre roofing system to angle light and for year round protection from the elements.

Property features include;

- Sun drenched north-east aspect overlooking 'Bridgewater Park'
- Dual frontage which provides cross flow ventilation to take advantage of the harbour breeze
- Spacious open plan living with windows on front & sides providing an abundance of natural light
- King sized master bedroom separated from the second &

Price : SOLD FOR \$1,400,000
Building Size : 19 sqm
View : <https://www.balmainrealty.com/1P0888>



Scott Robertson
 (02) 9818 8888

9818 8000

REALTY International
"World Wide Web of Buyers & Sellers"

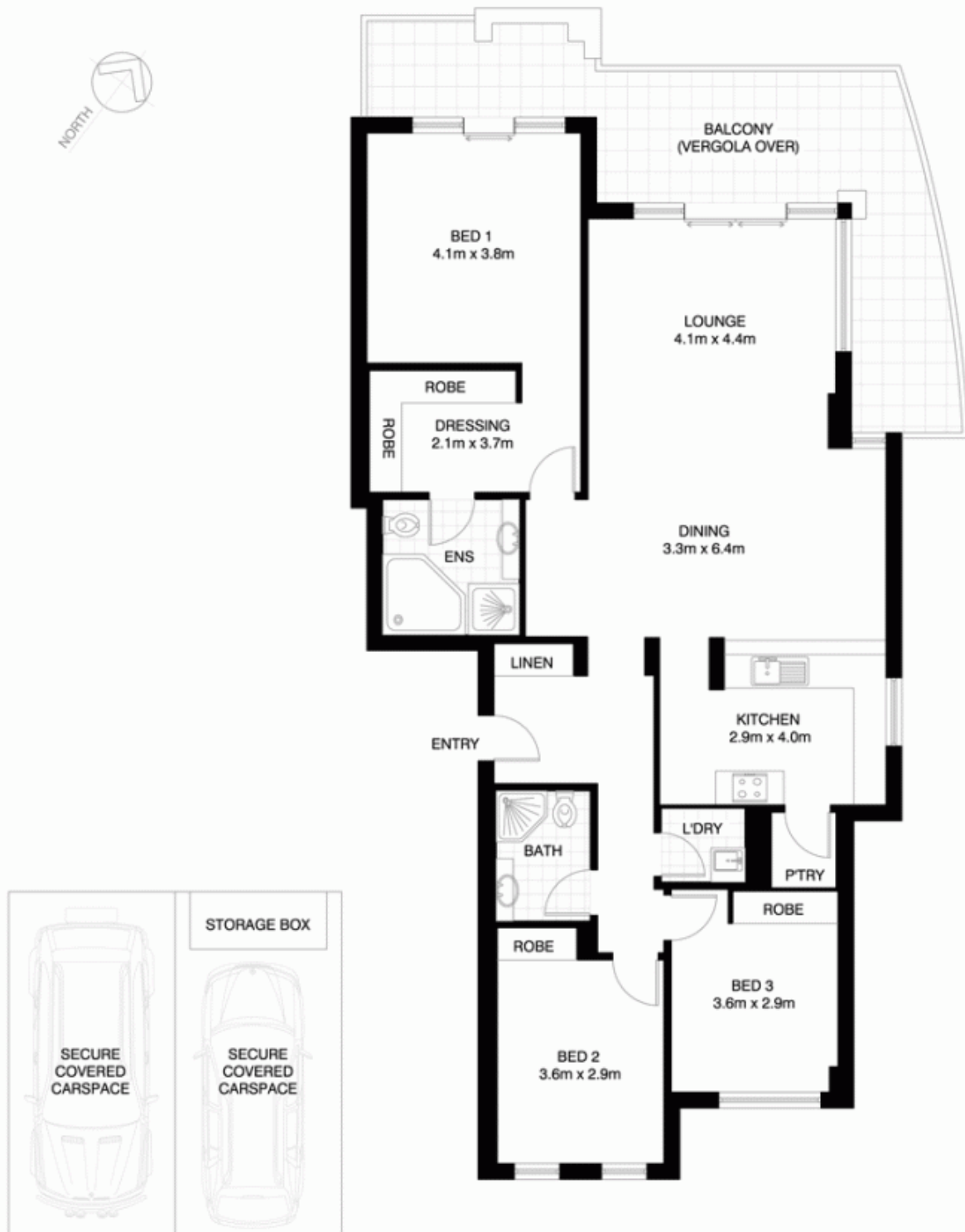

ROZELLE
612/3 WARAYAMA PLACE
"Mariners View" - Balmain Shores

*NOTE: ALL DIMENSIONS SHOWN ARE APPROXIMATE AND SHOULD ONLY BE USED AS A GUIDE. NOT TO SCALE.