



504/32 Warayama Place ROZELLE NSW

1 1 1

This air-conditioned one bedroom apartment offering a larger than average floor plan in the 'Balmain Shores' waterfront complex features stylish & spacious open plan interiors, 2x balconies, secure parking and access to resort like facilities.

So close to the action of Darling Street's abundance of cafes, restaurants, & boutique shopping with the 'Bay Run' offering approximately 8kms of walking & cycling paths along the harbour foreshore & express public transport on your doorstep this location has it all.

Property features include;

- Gourmet kitchen featuring granite benchtops, gas cooktop, oven, rangehood & dishwasher
- Spacious open plan air-conditioned living that flows onto a

Price : SOLD FOR \$500,000

View : <https://www.balmainrealty.com/1P0908>



Scott Robertson
(02) 9818 8888

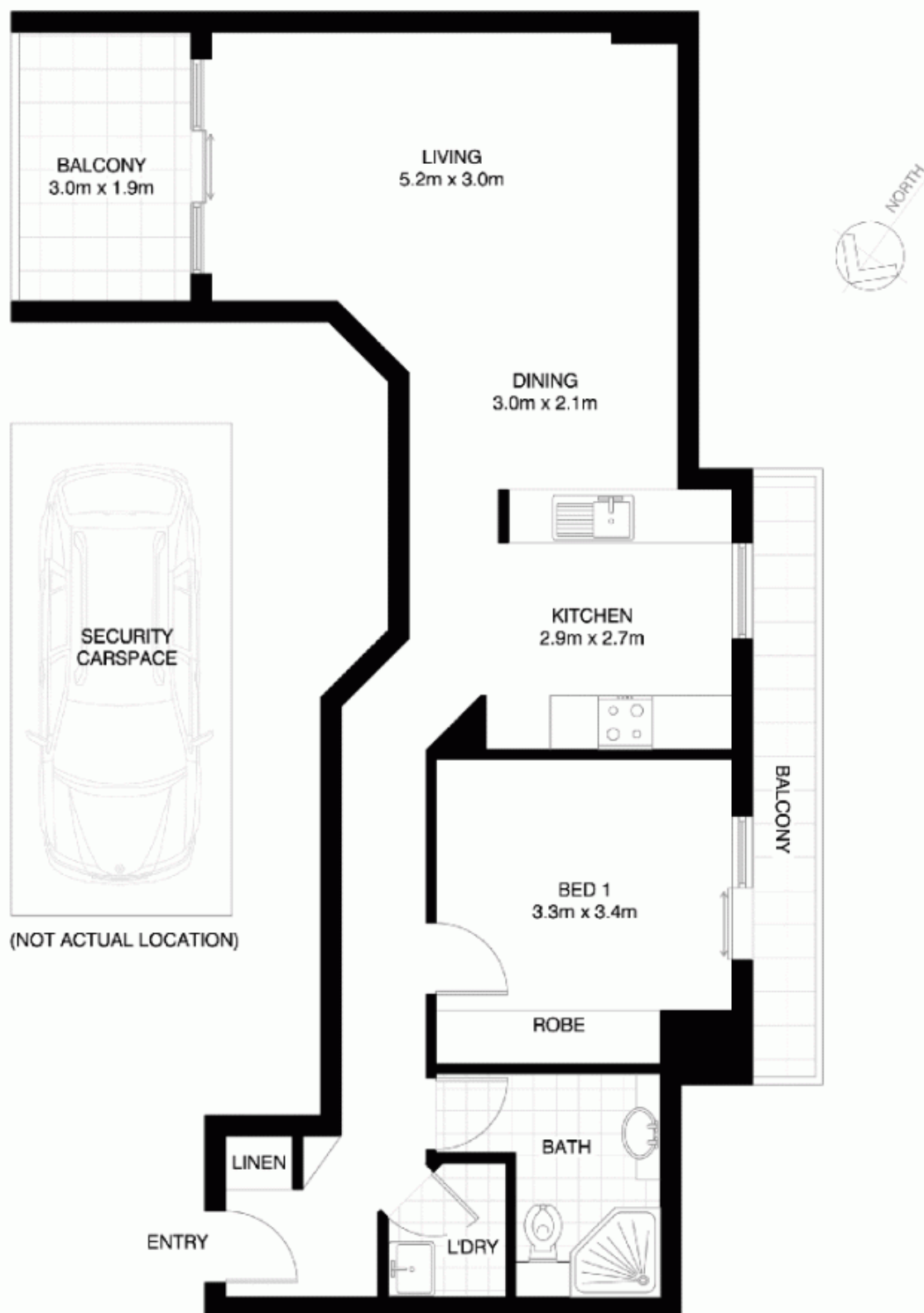

ROZELLE
504/32 WARAYAMA PLACE
"The Anchorage" - Balmain Shores

*NOTE: ALL DIMENSIONS SHOWN ARE APPROXIMATE AND SHOULD ONLY BE USED AS A GUIDE. NOT TO SCALE.