



105/8 Yara Avenue ROZELLE NSW

1 1 1

Sun Filled 18sqm Garden Courtyard with Water Views & Stylish Modern Interiors...

Superbly positioned apartment in a secluded, highly desirable setting in the popular 'Balmain Shores' waterfront complex just a short stroll from the heart of Rozelle village offering an abundance of cafes, restaurants, boutique shopping with easy access to harbour front parkland, the 'Bay Run' & express public transport.

This spacious one bedroom apartment features fresh & modern interiors that flow onto a large private sun-filled garden courtyard which takes in water views and offers access to resort like facilities.

Property features include;

**Price** : SOLD FOR \$531,500  
**Building Size** : 9 sqm  
**View** : <https://www.balmainrealty.com/1P0914>



**Scott Robertson**  
(02) 9818 8888

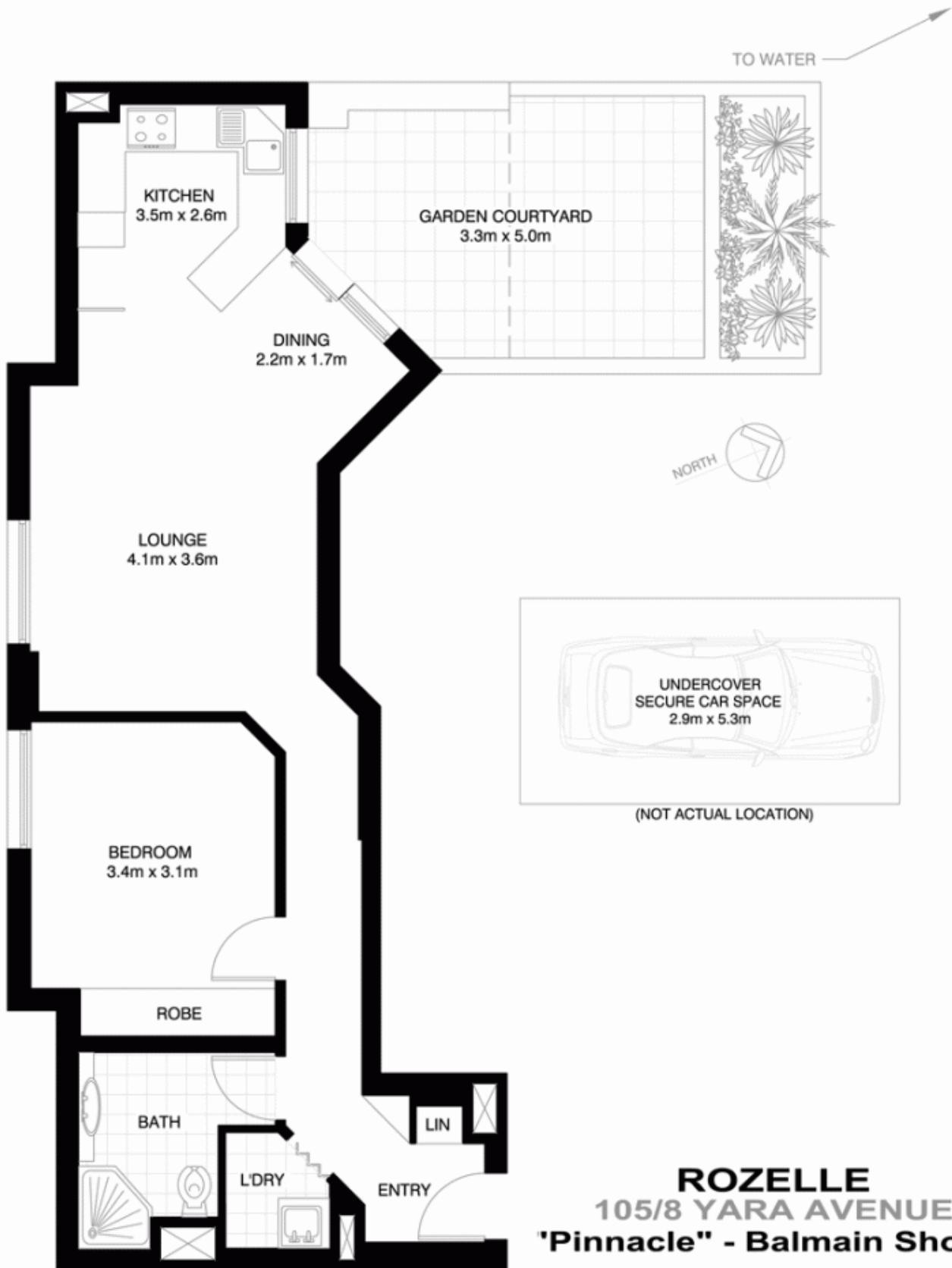

**ROZELLE**  
**105/8 YARA AVENUE**  
**"Pinnacle" - Balmain Shores**

\*NOTE: ALL DIMENSIONS SHOWN ARE APPROXIMATE AND SHOULD ONLY BE USED AS A GUIDE. NOT TO SCALE.