



404/6 Yara Avenue Rozelle NSW

1 1 1

Offering generous open plan living with windows on three sides this top floor apartment is bathed in natural light & and features two balconies.

Found within the popular 'Balmain Shores' waterfront estate in the 'Pinnacle' building comprising of only 4 levels giving residents access to first class facilities including a 25m indoor lap pool, outdoor pool, spa & gymnasium this property represents an excellent investment opportunity or ideal first home.

Getting around has never been easier with express public transport from your doorstep and Balmain & Rozelle villages just a short stroll away offering an abundance of cafes, restaurants, pubs & boutique shopping with waterfront parkland & the 'Bay Run' approximately 500m away.

Price : SOLD FOR \$512,500
Building Size : 81 sqm
View : <https://www.balmainrealty.com/1P0999>



Scott Robertson
 (02) 9818 8888

ROZELLE

404/6 YARA AVENUE

'Pinnacle' - Balmain Shores

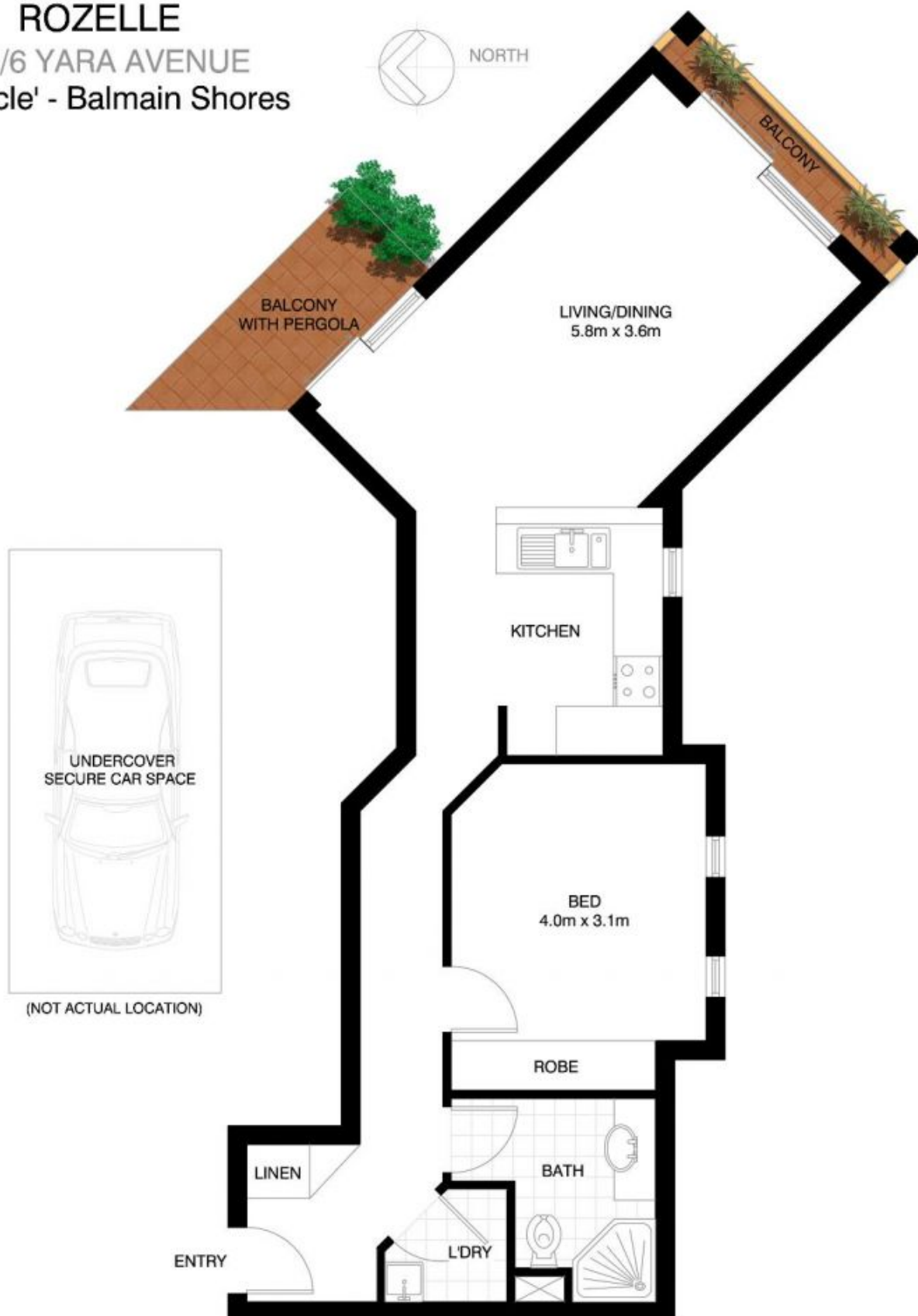

*NOTE: ALL DIMENSIONS SHOWN ARE APPROXIMATE AND SHOULD ONLY BE USED AS A GUIDE. NOT TO SCALE.