



**104/43 Terry Street Rozelle NSW**

**2**  **1**  **1** 

This modern terrace style apartment with double frontage offers excellent cross flow ventilation & ease of access via your own private garden courtyard.

Featuring polished timber floors with slim line roller shutter blinds throughout, low voltage down lights and ceiling fans with the addition of a large home office/study or 2nd bedroom this property is ideal for the professional on the go!

Property features include;

- Spacious open plan living that flows onto a north facing balcony with private leafy outlook
- Stylish kitchen with wrap around quartz benchtops, pull out pantry and stainless appliances
- Large main bedroom with mirrored built-in wardrobes,

**Price** : SOLD \$632,500  
**Building Size** : 115 sqm  
**View** : <https://www.balmainrealty.com/1P1014>



**Scott Robertson**  
**(02) 9818 8888**



## ROZELLE 104/43 TERRY STREET 'Atelier'



(NOT ACTUAL LOCATION)

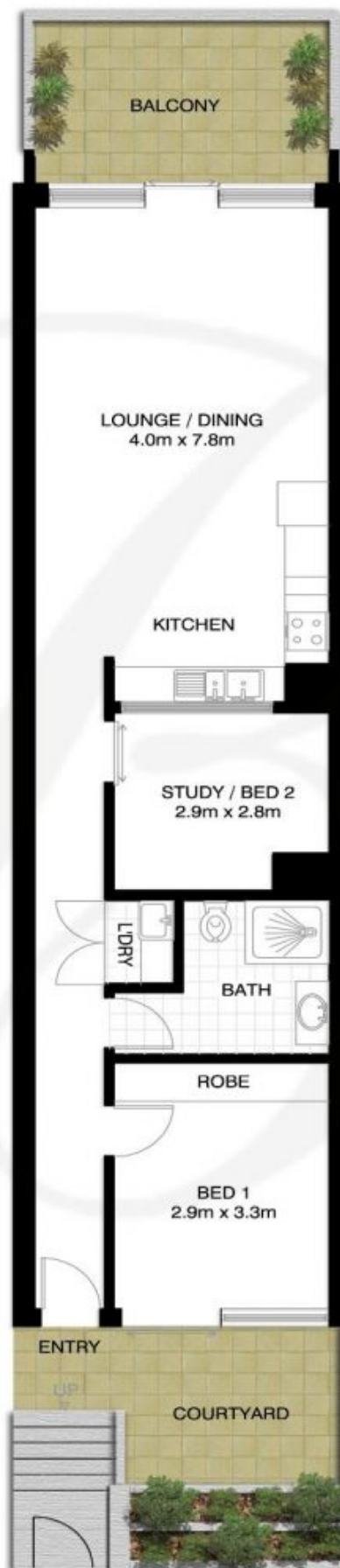

\*NOTE: ALL DIMENSIONS SHOWN ARE APPROXIMATE AND SHOULD ONLY BE USED AS A GUIDE. NOT TO SCALE.