



Level 2/126/5 Wulumay Close Rozelle NSW

2 2 2

Spacious Renovated 2 Bedroom + Study Apartment in Tranquil Waterfront Location

PROPERTY FEATURES:

- New paint throughout
- Brand new tiled floors in living areas & new carpet in bedrooms
- Generous living spaces set over 174sqm
- Additional study/home office, library or media room
- Covered north facing balcony taking in spectacular harbour views
- 2 king sized bedrooms both with mirrored built-in wardrobes & en-suite bathrooms
- Gourmet kitchen with gas cooking, dishwasher & ample storage
- Separate internal laundry & extra linen/storage cupboards
- Ducted air-conditioning throughout
- Double lock up garage with storage potential

Price : \$1,175 per week
Building Size : 212 sqm
View : <https://www.balmainrealty.com/1P1196>



Bronte Brown
(02) 9818 8888



ROZELLE 126/5 WULUMAY CLOSE "The Esplanades" - Balmain Cove

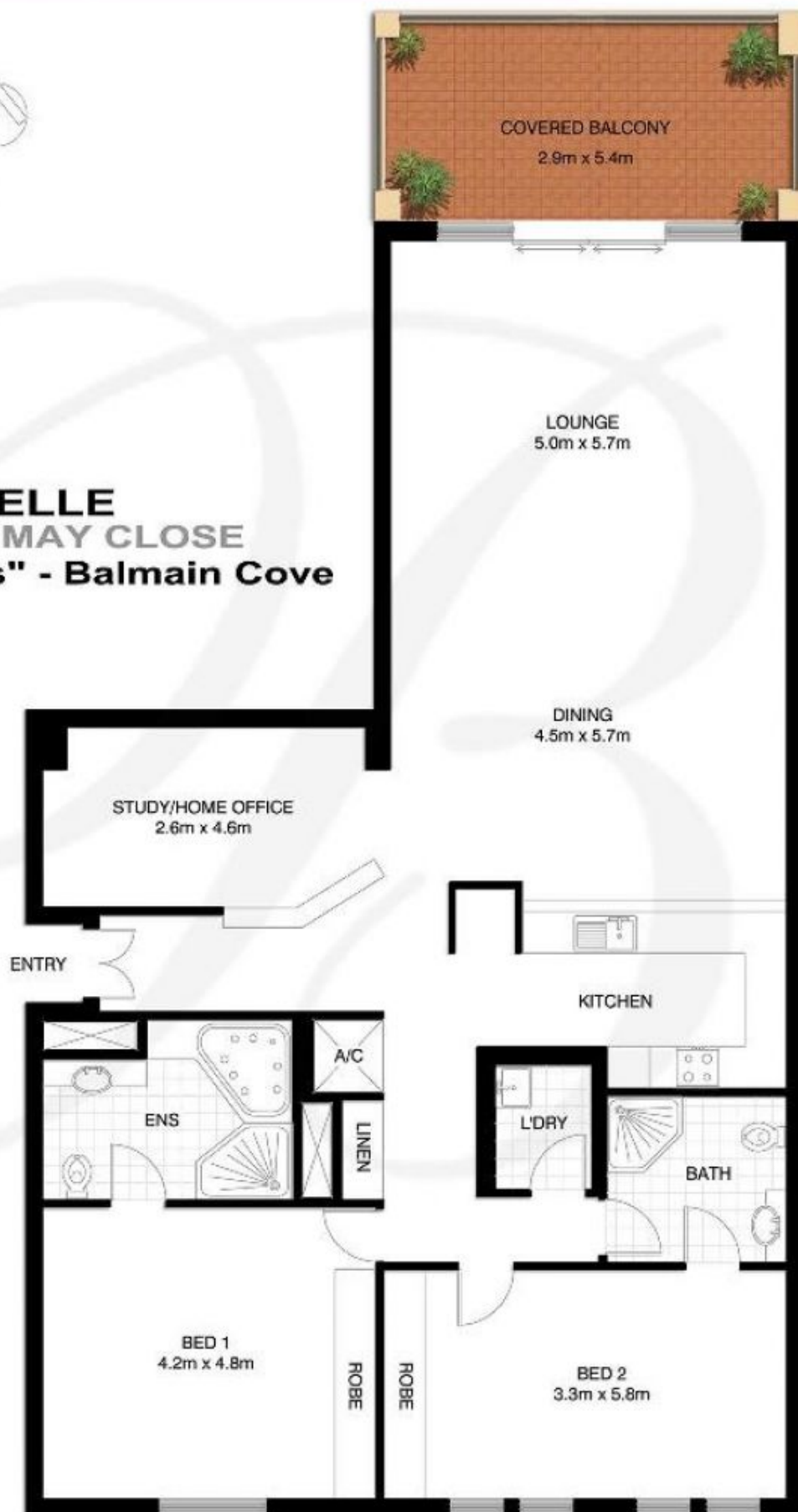

*NOTE: ALL DIMENSIONS SHOWN ARE APPROXIMATE AND SHOULD ONLY BE USED AS A GUIDE. NOT TO SCALE.