



## Level G/8 Yara Avenue Rozelle NSW



### PROPERTY FEATURES:

- Bright north facing lounge area with timber floorboards
- Sunny balcony with leafy outlook
- Double sized separate bedroom area with timber floors & mirrored built-in wardrobe
- 37sqm of internal living space
- Modern kitchen with gas cooking and dishwasher
- Modern bathroom with quality finishes
- Internal laundry with clothes dryer

### LIFESTYLE FEATURES:

- Access to the Balmain Shores facilities including indoor lap pool, outdoor plunge pool, gymnasium, spa & sauna
- Approx 3.8km from the QVB in the Sydney CBD with express buses to the city from Victoria Road
- Approx 0.5km to the Bay Run & Bridgewater Park
- Approx 1.4km to Darling Street's cafes, restaurants,

**Price** : \$450 per week  
**Building Size** : 41 sqm  
**View** : <https://www.balmainrealty.com/1P1230>



**Bronte Brown**  
**(02) 9818 8888**



**'Balmain Shores'**  
101/8 Yara Avenue, Rozelle

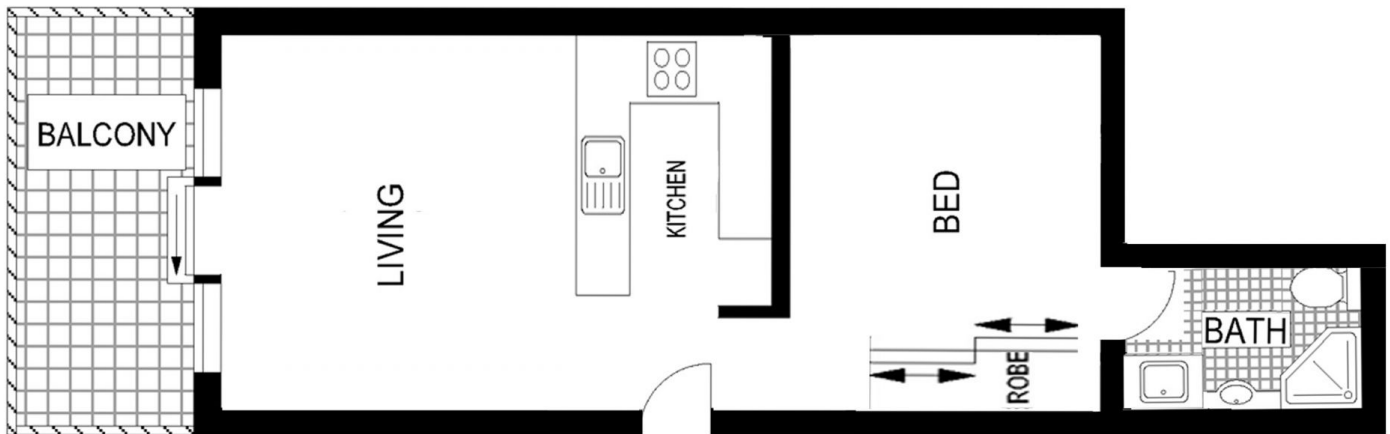

Every precaution has been taken to establish the accuracy of the included information but does not constitute any representation by the vendor or agent. All interested parties should make their own enquiries to verify the information contained in this document. Refer to contract of sale for actual inclusions.