



## 126/5 Wulumay Close Rozelle NSW

2 2 2

Taking in unobstructed harbour views and overlooking the beautiful manicured gardens this recently updated lavish two bedroom apartment features an additional study/ home office with large open plan living & dining that flows onto a large sun-filled north facing balcony.

**Price** : SOLD \$2,550,000  
**Land Size** : 212 sqm  
**View** : <https://www.balmainrealty.com/1P2075>

Positioned on the absolute waterfront of the tightly held 'Balmain Cove' resort like complex this stunning property offers a lifestyle opportunity second to none. Residents can enjoy use of two swimming pools, a well equipped gymnasium with an opportunity for the boating enthusiast to lease or purchase a deep water marina berth.



**Scott Robertson**  
**(02) 9818 8888**

Property features include;

- Generous house like proportions set over 174sqm
- Additional study/home office, library or sitting room set off

## ROZELLE 126/5 WULUMAY CLOSE "The Esplanades" - Balmain Cove

### PROPERTY DETAILS

#### AREA

Total	212sqm
Internal & Balcony	174sqm
Lock-up Garage	38sqm

#### OUTGOINGS

Strata	\$2,819pq
Council	\$284pq
Water	\$168pq

#### INSPECT

As advertised or by appointment

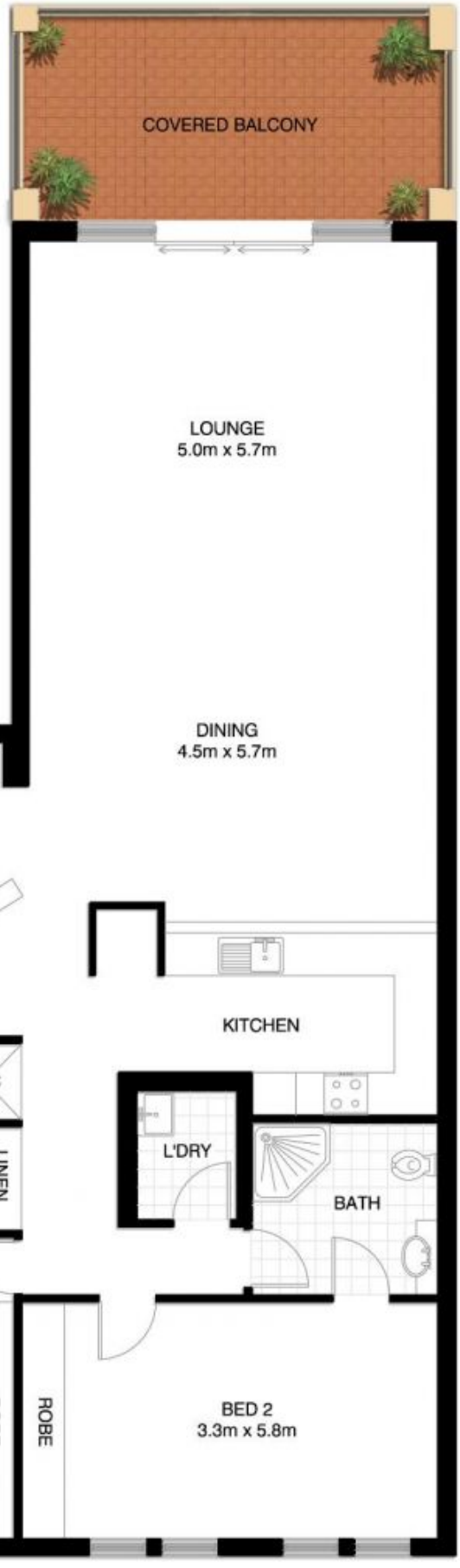

LOCK UP GARAGE  
10.7m x 3.7m

(NOT ACTUAL LOCATION,  
NOT TO SCALE)