



**6/65-69 Nelson Street Rozelle NSW**

2 2 1

A testament to luxury and contemporary sophistication, this superbly appointed designer apartment within the 'Nelson Court' boutique development of only 10 apartments and just 6 years young offers the ease and convenience of a walk-to-everywhere lifestyle.

This location is without a doubt one of the picks on the entire Balmain Peninsula. A quiet leafy street only a moments walk from the eclectic mix of Darling Street retailers including cafes, restaurants, bars, fashion boutiques & professional services, with express bus services to the Sydney CBD and to Balmain East Ferry. All just a short stroll to the waterfront and the ever popular Bay Run.

Property features include;

**Price** : SOLD \$1,675,000  
**Land Size** : 161 sqm  
**View** : <https://www.balmainrealty.com/1P2114>



**Scott Robertson**  
**(02) 9818 8888**

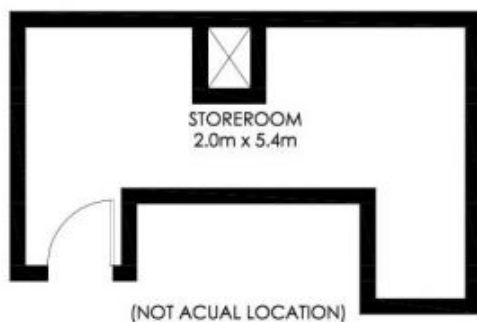

0 1 2 3 4 5 SCALE (METRES)

**ROZELLE**  
6/65-69 NELSON STREET  
"Nelson Court"

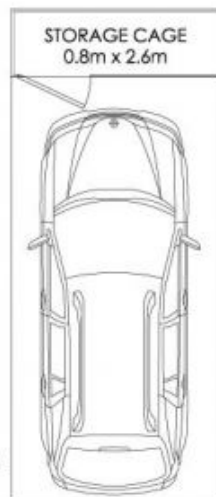

SECURE COVERED  
CAR SPACE  
5.2m x 2.6m

### PROPERTY DETAILS

#### AREA

Total	161sqm
Internal	87sqm
Terrace & Planter	47sqm
Car Space & Storage Cage	15sqm
Storeroom	12sqm

#### OUTGOINGS

Strata	\$1,348pq
Council	\$265pq
Water	\$168pq

#### INSPECT

As advertised or by  
appointment

\*PLANS SHOWN ONLY INDICATIVE OF LAYOUT. DIMENSIONS ARE APPROXIMATE.

**BALMAIN Realty**

1300 REALTY  
9818 8888  
balmainrealty.com