



Actual View from Balcony



**304/15 Warayama Place Rozelle NSW**

3  2  2 

North facing absolute waterfront apartments of this quality & size in this prime position rarely come available.

Found within the harbour-side enclave of 'Balmain Shores' this resort like complex offers residents access to first class amenities including swimming pools, spa, saunas & gymnasium, and is only a moments stroll to neighbourhood cafes, restaurants, pubs, an abundance of parkland, the Bay Run and express city transport.

Property features include;

- Located within the highly sought after Northpoint building, comprising of only 4 levels and positioned directly on the water/parkfront
- Expansive sun-drenched north facing balconies off the living room and master bedroom, overlooking the water and

**Price** : SOLD AT AUCTION \$2,415,000  
**Building Size** : 181 sqm  
**View** : <https://www.balmainrealty.com/1P2730>



**Scott Robertson**  
**(02) 9818 8888**

## PROPERTY DETAILS

### AREA

Total	181sqm
Internal	127sqm
Balconies	18sqm
Parking	36sqm

### OUTGOINGS

Strata	\$2,761p/q
Council	\$325p/q
Water	\$179p/q

### INSPECT

As advertised or by private appointment.



# 304/15 WARAYAMA PLACE ROZELLE

"Northpoint" - Balmain Shores

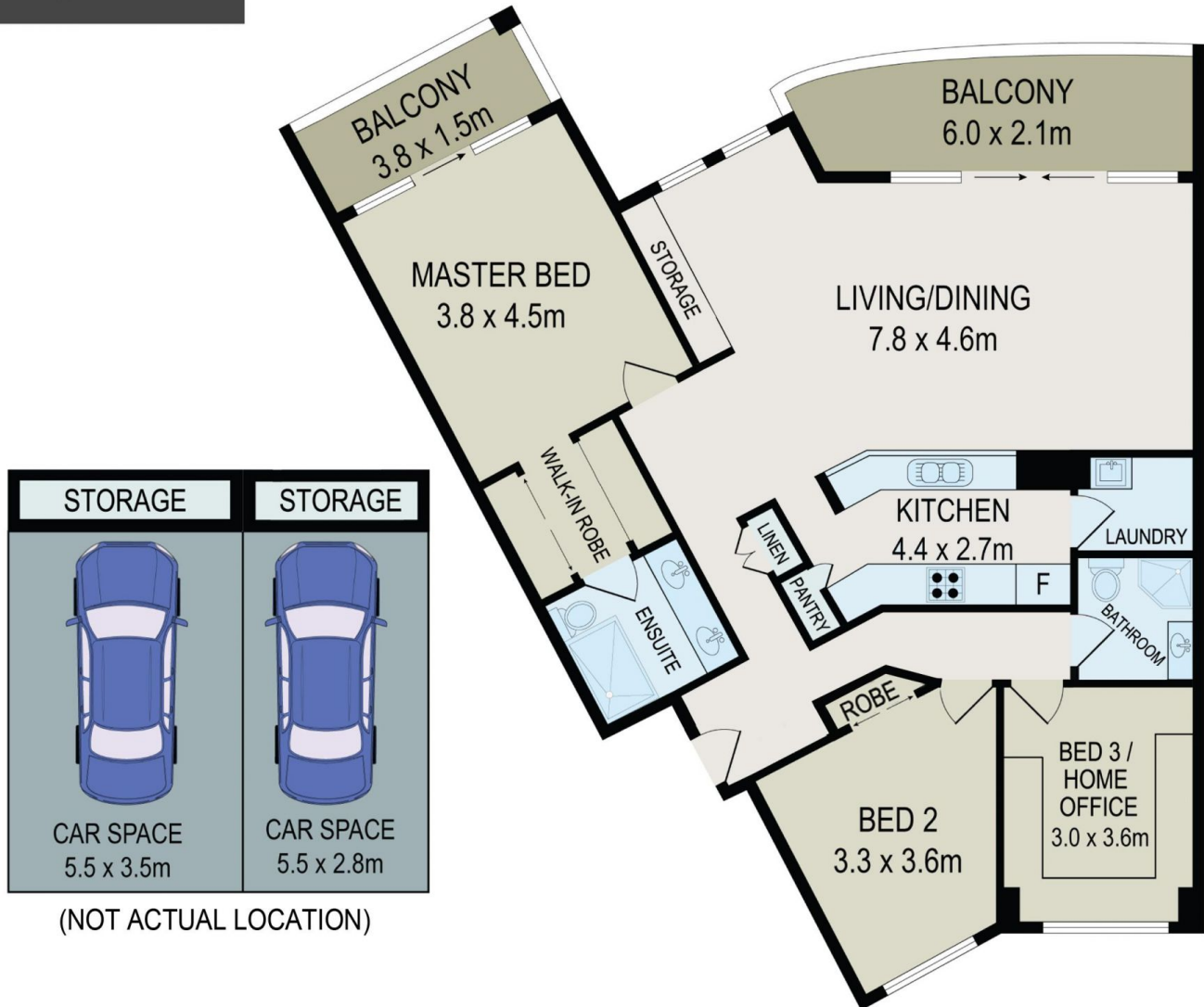

0 1 2 3 4 5

All information contained herein is gathered from all sources we believe to be reliable. However we cannot guarantee its accuracy and interested parties should rely on their own enquiries.

**BALMAIN**Realty

1300 REALTY  
9818 8888  
balmainreality.com