



Level 1/41 Terry Street Rozelle NSW

2 1 1

Stylish Terrace Style Apartment with Parking & Storage Cage

Price : Leased! \$680 per week

View : <https://www.balmainrealty.com/1P2773>

This immaculate & stylish contemporary terrace style apartment situated in the popular "Atelier" building features an additional home office/second bedroom and offers direct street access off a private garden courtyard.

Located just a minutes easy walk to Darling Street's restaurants, cafes & pubs with express public transport just metres from your doorstep taking you into the Sydney CBD in less than 10 minutes this is the perfect address.

Property features include;

- Freshly painted and new carpet throughout
- Air conditioning installed in lounge room



James Middleton
(02) 9818 8888

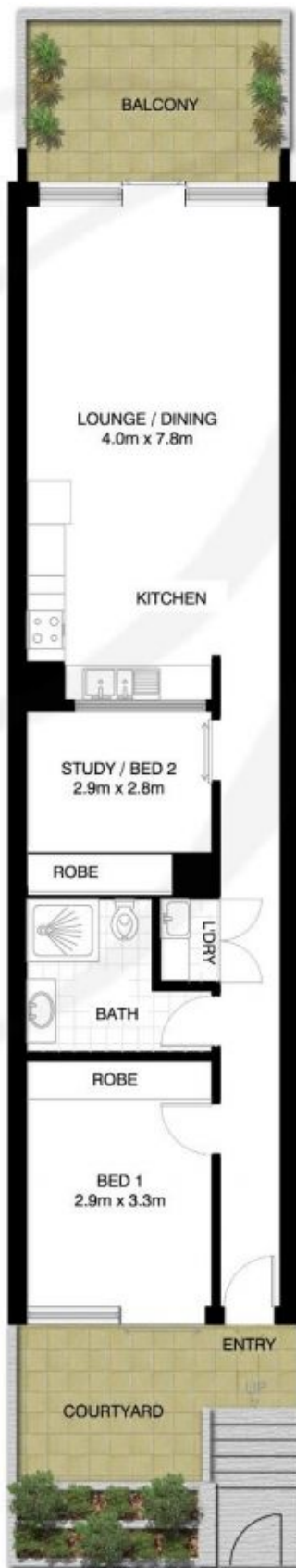

(NOT ACTUAL LOCATION)

ROZELLE
110/41 TERRY STREET
'Atelier'