



18/3 Wulumay Close Rozelle NSW

3 2 2

Set within the tightly held 'Balmain Cove' complex and positioned on the absolute waterfront of 'The Landings' building, this oversized ground floor apartment offers spacious & luxurious renovated interiors which flow onto two large courtyards, one with direct private gate access to the waterfront & marina facilities for the boating enthusiast.

Located just 4kms from the Sydney CBD and just a short stroll from express city transport, schools, neighbourhood restaurants, cafes & shops along with Darling Street's renowned retail strip.

Property features include;

- Extensive indoor/outdoor living of house like proportions with a sun-filled northerly aspect
- Exquisitely renovated interiors with wide Blackbutt timber

Price : SOLD PRIOR TO AUCTION
Building Size : 283 sqm
View : <https://www.balmainrealty.com/1P3218>



Scott Robertson
(02) 9818 8888

PROPERTY DETAILS

AREA

Total 283sqm
 Internal & External 249sqm
 Parking 34sqm

OUTGOINGS

Strata \$4613p/q
 Council \$310p/q
 Water \$151p/q

INSPECT

As advertised or by private appointment.

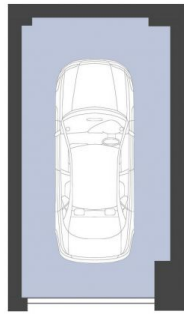

LOCK UP GARAGE
5.7m x 3m

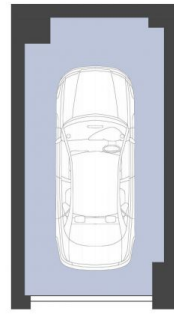

LOCK UP GARAGE
5.6m x 2.8m

(NOT ACTUAL LOCATION)

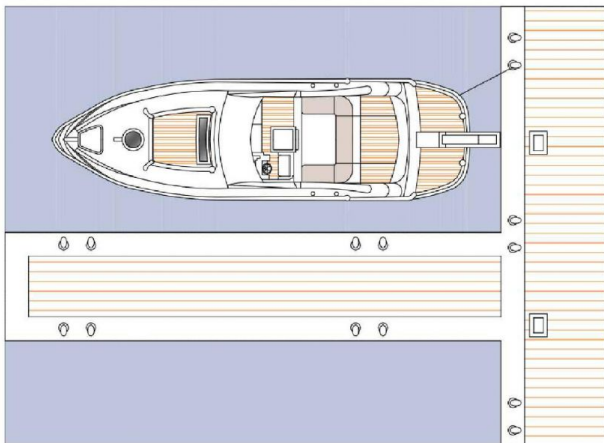
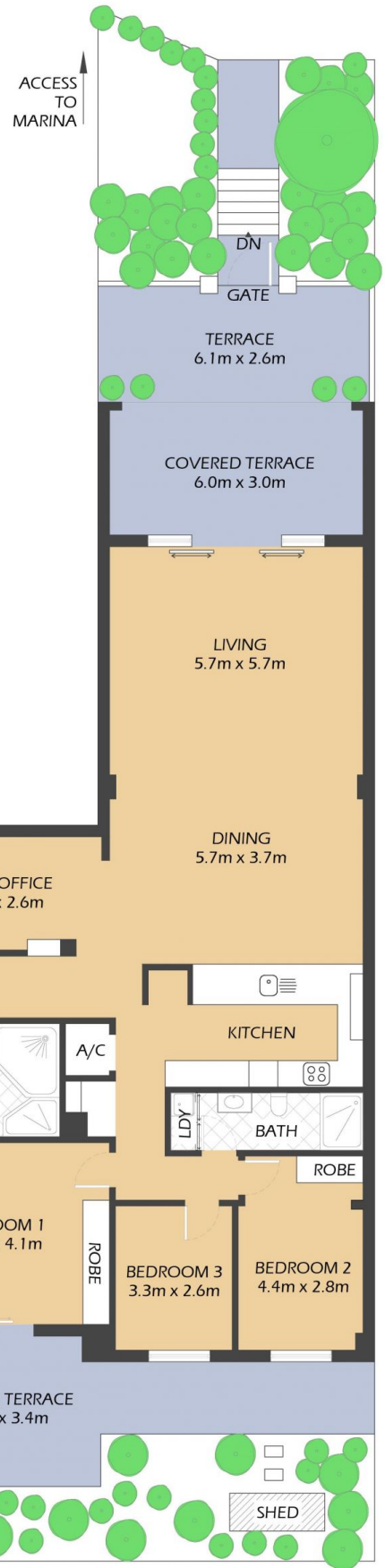

(OPTIONAL- 12 METRE MARINA BERTH)

18/3 WULUMAY CLOSE

ROZELLE

"The Landings" - Balmain Cove



*FLOOR PLAN MEASUREMENTS ARE APPROXIMATE AND FOR ILLUSTRATIVE PURPOSES ONLY.

BALMAINRealty

9818 8888

BALMAINREALTY.COM