



201/43 Terry Street Rozelle NSW

1 1 1

Set within the popular 'Atelier' complex, this stylish & contemporary one bedroom apartment features spacious open plan interiors plus an additional study area.

Positioned just a short stroll from Darling Street's vibrant cafes & restaurants, parkland and the 'Bay Run' with walking and cycleways along the harbour foreshore, as well as express city transport from your doorstep, this location has it all.

PROPERTY FEATURES:

- Spacious open plan living/dining that flows onto a large balcony
- Additional study area featuring desk & cabinetry
- Gourmet kitchen featuring pull out pantry and stainless appliances including gas cooktop, oven, rangehood &

Price : SOLD OFF-MARKET
Building Size : 83 sqm
View : <https://www.balmainrealty.com/1P3316>



Scott Robertson
(02) 9818 8888



Hayden Hedley
(02) 9818 8888

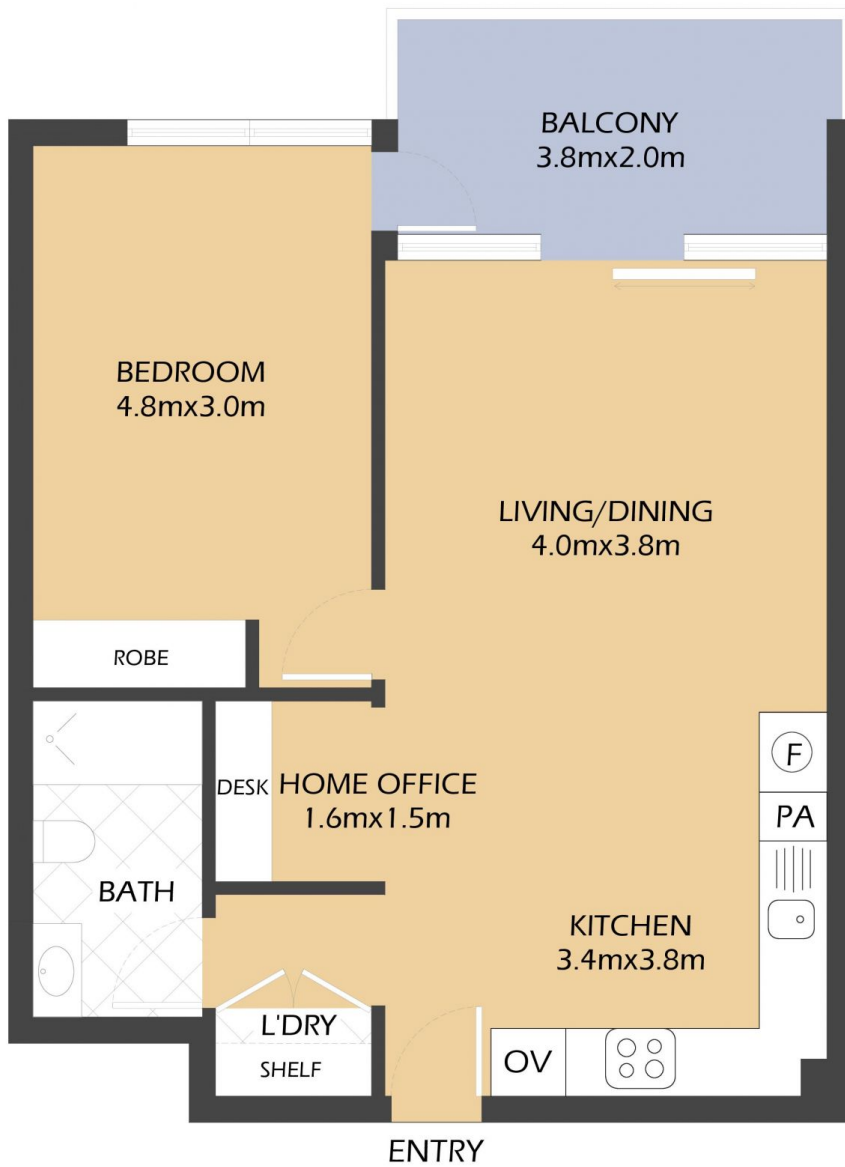

SECURE UNDER COVER
CAR SPACE
5.3m x 3.0m
(NOT ACTUAL LOCATION)



201/43 TERRY STREET
ROZELLE
'Atelier'



*FLOOR PLAN MEASUREMENTS ARE APPROXIMATE AND FOR ILLUSTRATIVE PURPOSES ONLY.

PROPERTY DETAILS	
AREA	
Total	83sqm
Internal & External	60sqm
Parking & Storage	23sqm
OUTGOINGS	
Strata	\$846pq
Council	\$331pq
Water	\$150pq

BALMAINRealty

9818 8888

BALMAINREALTY.COM