



## Level 1/28 Warayama Place Rozelle NSW

1 1

Desirable Studio Apartment within the Popular 'Balmain Shores' Complex

Found within the highly sought after 'Balmain Shores' complex. This privately positioned studio has access to resort style amenities and unbeatable convenience to local eateries, express city transport & the harbour foreshore.

### PROPERTY FEATURES:

- Spacious open plan layout that opens onto a private sun-drenched north facing balcony
- Freshly painted interiors, new plush carpet and blinds
- Gourmet kitchen featuring granite benchtops, ample storage & stainless steel appliances including gas cooktop, oven, rangehood & dishwasher
- Generous well defined bedroom area separated from the

**Price** : Leased! \$475 per week  
**Building Size** : 41 sqm  
**View** : <https://www.balmainrealty.com/1P3456>



**Jo Kennedy**



**Suzanne MacMillan**  
**(02) 9818 8888**

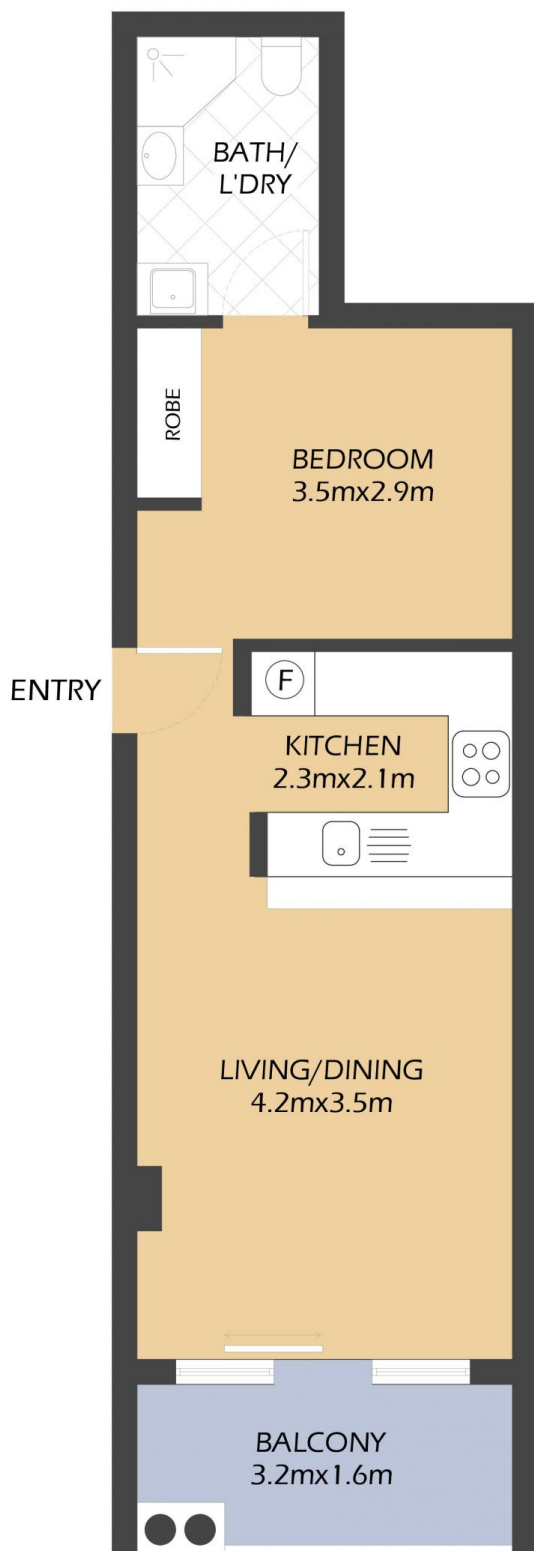

108/28 WARAYAMA PLACE  
ROZELLE  
"Crestview" – Balmain Shores

PROPERTY DETAILS

AREA

Total	41sqm
Internal	37sqm
Balcony	4sqm

OUTGOINGS

Strata	\$790pq
Council	\$331pq
Water	\$149pq



\*FLOOR PLAN MEASUREMENTS ARE APPROXIMATE AND FOR ILLUSTRATIVE PURPOSES ONLY.

**BALMAIN**Realty

9818 8888  
BALMAINREALTY.COM