

301/41 Terry Street Rozelle NSW

1 1 1

Situated within the popular 'Atelier' complex, a modern, well maintained building with low strata levies, located just a moments stroll from express city transport, the waterfront with Bridgewater Park & the Bay Run, with an array of local eateries & shops on your doorstep.

This is a rare opportunity to secure a premium top floor apartment with modern interiors, featuring secure undercover parking and two storage cages in a highly sought after location.

PROPERTY FEATURES:

- Spacious open plan living areas with high Cathedral like ceilings that open onto a large balcony
- Functional kitchen with stone benchtops featuring pull out pantry, stainless steel appliances including gas cooktop,

Price : SOLD \$740,000
Building Size : 69 sqm
View : <https://www.balmainrealty.com/1P3352>



Scott Robertson
(02) 9818 8888



Nick Van Venrooy
(02) 9818 8888

ADDITIONAL
LOCK-UP
STORAGE CAGE
2.0m x 2.0m

LOCK-UP
STORAGE CAGE
2.5m x 2.4m

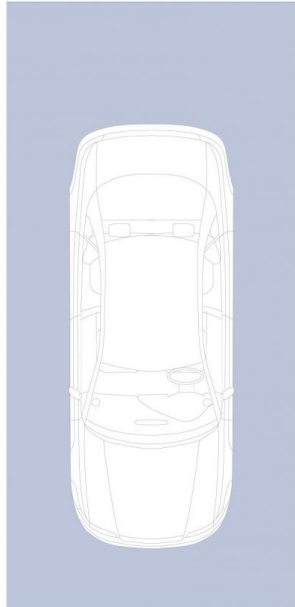

SECURE UNDERCOVER
CAR SPACE
5.5m x 2.5m

(NOT ACTUAL LOCATION)

301/41 TERRY STREET

ROZELLE

"ATELIER"



*FLOOR PLAN MEASUREMENTS ARE APPROXIMATE AND FOR ILLUSTRATIVE PURPOSES ONLY.

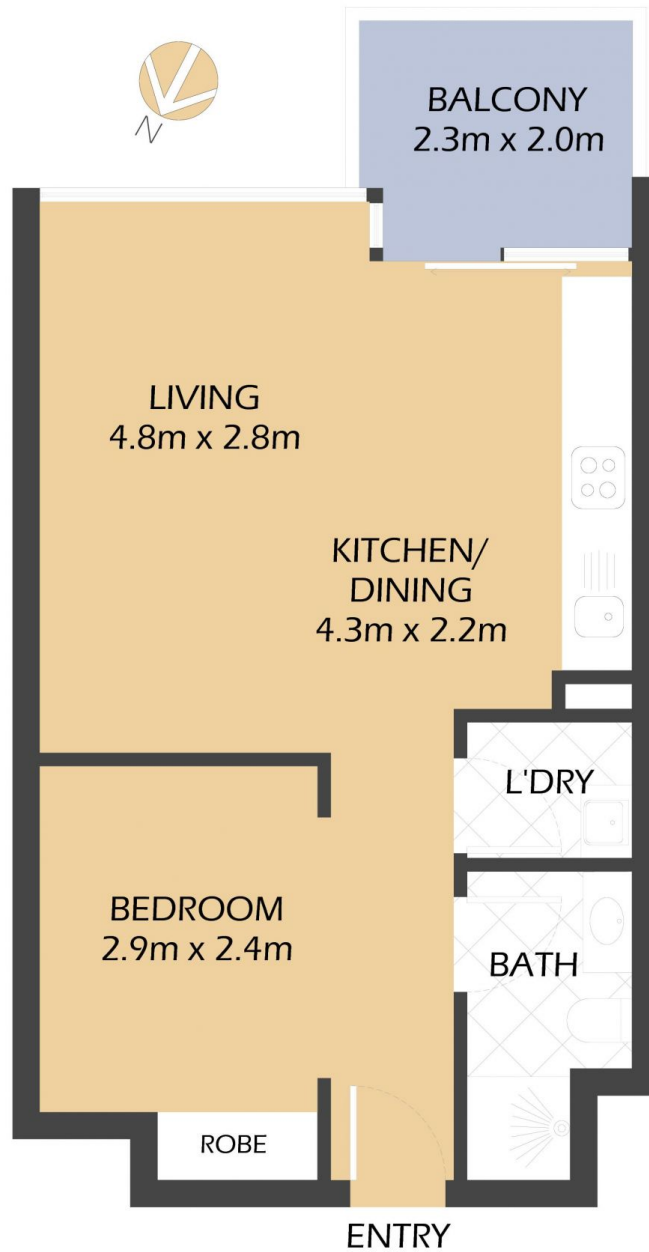

PROPERTY DETAILS	
AREA	
Total	69 sqm
Internal & External	45 sqm
Parking & Storage	20 sqm
Additional Storage Cage	4 sqm
OUTGOINGS	
Strata	\$809p/q
Council	\$338p/q
Water	\$158p/q