



7/3 Wulumay Close Rozelle NSW

5 3 3

Positioned on the absolute waterfront of 'Balmain Cove' this lavish oversized penthouse apartment with cathedral ceilings occupies a generous 302sqm of living space and takes in stunning northerly panoramic harbour views.

Recently undergoing an extensive renovation throughout with no expense spared, this incredible home offers a rare combination of oversized proportions and build quality that would be difficult to replicate anywhere in Sydney today.

Sit back and admire the passing watercraft sail by, or simply enjoy alfresco dining year-round from an extensive entertainer's terrace with a favourable due north aspect.

ACCOMMODATION:

- 5 bedrooms

Price : SOLD \$7,800,000
Building Size : 381 sqm
View : <https://www.balmainrealty.com/1P3674>



Scott Robertson
(02) 9818 8888

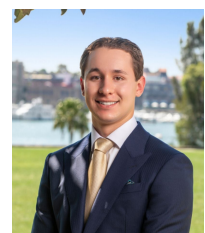

Nick Van Venrooy
(02) 9818 8888

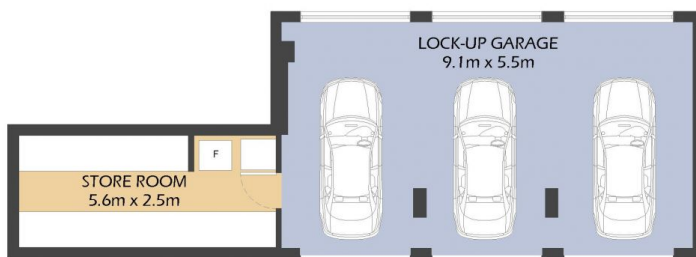

(NOT ACTUAL LOCATION)

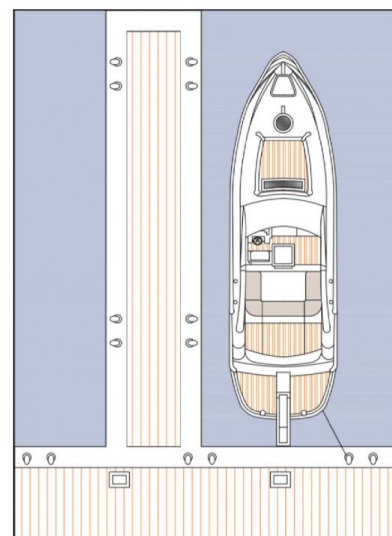

12 METRE MARINA BERTH
(OPTIONAL)

7/3 Wulumay Close

ROZELLE

'The Landings' – Balmain Cove



PROPERTY DETAILS

AREA

Total	381sqm
Internal & External	302sqm
Garage & Storeroom	65sqm
Additional Storeroom	14sqm

OUTGOINGS

Strata	\$11,017p/q
Council	\$353p/q
Water	\$173p/q

*FLOOR PLAN MEASUREMENTS ARE APPROXIMATE AND FOR ILLUSTRATIVE PURPOSES ONLY.

BALMAINRealty

9818 8888

BALMAINREALTY.COM